



GARDEN GUIDE & WALKING TOUR



We invite you to take a self-guided walking tour through this enchanted hideaway, graced by terraced gardens, Arts and Crafts follies, stately fountains, hidden grottoes, romantic woodlands, and winding paths. Designed in the early 20th century, Greenwood offers visitors a peaceful haven in which to connect with nature and the arts, set against a background of startling beauty and the artifacts of unique family history. If you have questions during your tour, our staff and volunteers will graciously assist you in the garden.

*Connecting people with nature
and the arts in a historic garden oasis.*

274 Old Short Hills Road, Short Hills, NJ 07078
(973) 258-4026 · info@greenwoodgardens.org



North Ridge Parking Lot

Ticket Kiosk

Cottage Parking Lot

MAIN DRIVE

- 1 Cottages
- 2 Main House
- 3 Reflecting Pool Terrace
- 4 Croquet Lawn
- 5 Garden of the Gods
- 6 Summerhouse
- 7 Teahouse
- 8 Ponds
- 9 Farm Allee
- 10 Cascade
- 11 West Walk

- Ticket Kiosk
- North Ridge Parking Lot
- Cottage Parking Lot
- Welcome Center, Gift Shop and First Aid
- Stroller Parking
- Restrooms
- Service Area Closed to Visitors

DIRECTIONS FROM THE PARKING LOTS TO THE GARDEN

From the North Ridge Lot, follow the sidewalk and turn left onto the Cottage Walk toward the Main House and Garden. Stop #1 on your tour comprises the Cottages and the First Tee.

From the Cottage Lot (former Day Era Tennis Court), walk down the ramp and turn right. Go straight until you reach the first stop on your tour: the First Tee and the Cottages. After that, turn back toward the Main House and Garden.

ACCESSIBILITY The restored Main Terrace with partial views of the Garden is accessible to all visitors. The remainder of the historic landscape at Greenwood Gardens is not accessible by wheelchair or stroller given that the uneven terrain is difficult to navigate. Stroller parking is available at the Main House. Certified service dogs are welcome. Note: To help protect yourself against ticks, please use tick spray and check yourself for ticks after leaving.

EMERGENCIES In case of an emergency, please dial 911 and notify the nearest member of Greenwood Gardens staff immediately. A first aid kit and AED machine are located in the Welcome Center of the Main House.

SELF-GUIDED WALKING TOUR

Follow the numbered entries which correspond to the numbered posts at each stop on the site. For more historical information, see insert.

1 COTTAGES, GARAGE, TENNIS PAVILION, AND FIRST TEE



The Cottages were renovated between 1925 and 1926 by William W. Renwick who incorporated tile and stucco exteriors and Rookwood faience tiles to match the Main House. Rookwood ceramic plaques identify the year each building was renovated. A portion of Joseph P. Days' staff was housed here, which at its peak in the 1920s numbered 100. A five-bay garage adjoined the annex with the additional staff quarters above. A Rookwood ceramic tile featuring a motor car with a license plate proclaiming the year "1927" adorns the garage.

The former Tennis Pavilion overlooks the Cottage Parking Lot, which was originally a clay tennis court in the Day Era. At the south side of the lot is the Tennis Loggia, whose curved pergola and arched gateway once led from the Main House to the former riding stables, service buildings, and four-acre vegetable garden.

The First Tee of Joe Day's former private nine-hole golf course is located between the Main House and the 1926 Cottage, just beyond the urn.

2 MAIN HOUSE, EAST PAVILION (ADELAIDE'S), AND MAIN LAWN



The 1950 Georgian Revival Blanchard home comprises the Welcome Center, a gift shop, first aid, and staff offices. The East and West Pavilions flank the sides of the home with archway overpasses. Peter P. Blanchard, Jr. and his wife Adelaide Childs Frick Blanchard would occasionally take breakfast in the East Pavilion, now referred to as Adelaide's in honor of Mrs. Blanchard. Housed there is the magnificent wrought iron and gilt bronze Bird of Paradise Gate, crafted by Edward F. Caldwell & Co., the pre-eminent designer of decorative metalwork from the end of the 19th century through the 1940s. The West Pavilion, originally a two-car garage, was converted to public restrooms in 2009.

3 REFLECTING POOL TERRACE WITH D-SHAPED POOL

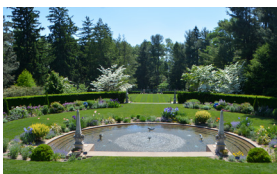

Original to the design of Pleasant Days, the D-Shaped Pool remains the focal point of this terrace. The three lead dolphins spouting water were formerly in situ at Clayton, Adelaide Blanchard's childhood home on Long Island, and were originally installed in 1965. The stairs, pool, fountain, and grotto on this terrace were part of an extensive restoration project completed in 2020.

4 CROQUET LAWN



The Day family enjoyed playing croquet on the aptly named Croquet Terrace, which was formerly flanked by pergolas for shade and stored croquet equipment. Peter Blanchard Jr.'s most significant alteration was the installation of double rows of boxwood hedging, guiding one to the steps leading down to the Garden of the Gods.

The boxwood hedges remained until 2020 when they were removed to accommodate the Main Axis renovation.

5 GARDEN OF THE GODS



During the Day Era, the Garden of the Gods was home to a series of painted busts of Roman divinities placed between the paired columns. The pool featured statues modeled after the Day children. During the Blanchard Era, the pool was ringed with boxwood. Now, the bronze sculpture of the Boy with Waterfowl by Emilio

Angela is centered in the Garden of the God's pool. This pool was part of the 2020 restoration project.

6 SUMMERHOUSE

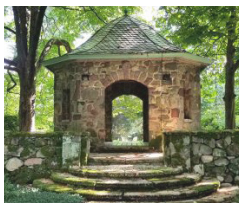

The Summerhouse was constructed by Italian stone masons in 1920 using local sandstone and basalt and is surrounded by four granite water basins. The building was originally electrified, as evidenced by the light switch on the inside wall. The floor of the structure consists of colorful tiles manufactured by Fulper, Inc. in Flemington, New Jersey. Four horse chestnut trees, each well over 100 years old, were strategically planted to shade the Summerhouse. The stone polyhedral sundial on the path leading to the Teahouse was formerly in situ at Clayton, Adelaide's childhood home on Long Island.

7 TEAHOUSE

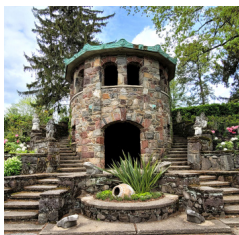

Built circa 1920, tea was prepared in the Teahouse during the Day Era utilizing the sink and fireplace. The ceiling of the lower level is studded with Rookwood ceramic pieces and Fulper tiles decorate the floors. At one time, a water feature with descending basins, known as the Teahouse Water Garden, extended out from the front of the lower entrance. The five granite frogs are original Day Era garden ornaments. The limestone chess piece sculptures that line the stairway of the Teahouse, as well as the ancient granite Chinese Foo dogs that overlook the walk nearby, were added by the Blanchard Family.

8 PONDS



Peter Blanchard, Jr. added two ponds adjacent to one another in 1965 to create a natural habitat for fish and waterfowl. These ponds replaced an apple orchard. At the terminus of this view are wrought iron gates created for the Frick residence in New York City, built between 1912 and 1914, according to designs by architects Carriere and Hastings.

Visitors are cautioned to remain a safe distance from the ponds. Please do not feed, chase, or provoke Greenwood's domestic animals and/or wildlife

9 FARM ALLÉE AND BARNYARD

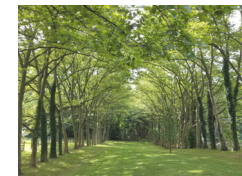

Both the Days and the Blanchards celebrated rural life and farming on a small scale. The Day family owned cows, pigs, turkeys, chickens by the hundreds, horses, and a large array of dogs. A greenhouse provided fresh citrus fruit and flowers year-round.

Peter Blanchard, Jr. greatly enjoyed daily walks around the property accompanied by a mixed pack of corgis and Labrador retrievers. The Blanchard family raised ducks, geese, guinea hens, turkeys, pheasants, peacocks, and fancy pigeons, while horses and sheep grazed the meadows. Currently, the Greenwood farm is home to chickens, turkeys, geese, and ten hives of honeybees maintained in partnership with Overlook Medical Center.

10 CASCADE RENOVATION



When its restoration is completed this fall, the iconic seven-tiered Cascade will signify the transformation of this historic garden. It will enable visitors to take in the original extensive views from atop the Upper Exedra, experience the peaceful effect of the sight and sound of

water flowing down the repaired basins amidst beautiful new plantings, walk on the majestic staircases relined with stepped walls, and sit on the Lower Exedra's gracious stone curved bench from which to marvel at this monumental design engineered a century ago.

11 THE WEST WALK

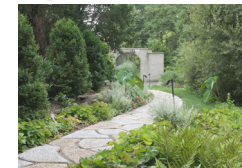

Alongside the Main House and leading to the former First Tee, this area was once used by the Days as a laundry-drying area. The Blanchards repurposed this section of the Garden and added eight dog kennels. The West Walk now showcases some uncommon shrubs such as *Platycrater arguta*

(hydrangea relative) and *Neillia sinensis* (rose family). Every year, on the upper portion of the West Walk adjacent to the First Tee, Greenwood creates an exuberant display with tropical plants, colorful annuals, and perennials.